



Welcome
to

**To the
Sixth
North
American
Conference
on**

**Shaken
Baby
Syndrome**

*Park City, Utah
September 13-16, 2006*

PROGRAM

Welcome to

The Sixth North American Conference on Shaken Baby Syndrome



Park City, Utah - September 13 -16, 2006

The National Center on Shaken Baby Syndrome welcomes you to the Sixth North American Conference on Shaken Baby Syndrome in Park City, Utah.

We are proud to have reached our tenth year in providing these valuable conferences. We appreciate your continued support. Once again, we have assembled the most respected faculty in the world on shaken baby syndrome. We hope this conference provides you with the



Photo courtesy of Latham Jenkins / Park City Chamber and Visitors Bureau

Dine outside at many of Park City's award-winning restaurants.

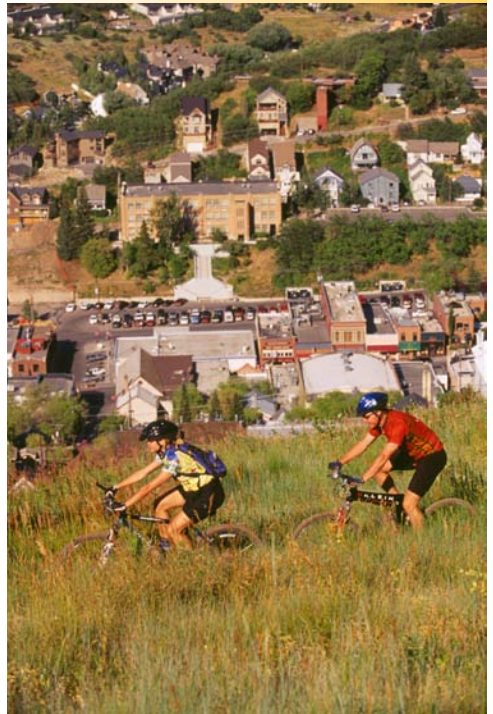

Enjoy the mountain air and scenic views through a variety of outdoor recreation opportunities.

National Center on
**Shaken Baby
Syndrome**

www.dontshake.org

www.dontshake.org

Conference Supporters

American Academy of Pediatrics
Dr. W.C. Swanson Family Foundation
Foresters™



McKay-Dee Hospital
National Association of Children's Hospitals and Related Institutions (NACHRI)
National Shaken Baby Coalition
Primary Children's Medical Center, Division of Safe and Healthy Families
Primary Children's Medical Center, Pediatric Education Services
Southeast Mechanical Contractors



We recognize Neutekprint as a long-time supporter to the National Center on Shaken Baby Syndrome and thank them for their generous contribution of the printing of this program.

Conference Planning Committee

Marilyn Barr, Conference Director
Bridgett Tasker, Conference Coordinator

Agrey, Noreen, BA, BEd	Murray, Jonell, MS
Alexander, Sandra, MEd	Poole, Michele, Parent
Alexander, Randall, MD, PhD, FAAP	Prosper, Lana, Constable
Barr, Ronald G., MDCM, FRCPC	Reece, Robert, MD
Chadwick, David L., MD	Rowse- Schmidt, Pamela, RN
Christian, Cindy, MD, FAAP	Schreiter, Wendy, Parent
Dycus, Debra, Parent	Simmons, Janet, Parent
Fisher, Marjory	Swenson, Jane, RN, MS, CPNP
Franks, Steven, BS	Vieth, Victor, JD
Ising, Denise, Parent	Wheeler, Philip, DC
Jenny, Carole, MD, MBA	
Khader, Joy, MS, APRN	
Levin, Alex, MD, MHSc, FAAP, FAAO, FRCSC	

National Center on Shaken Baby Syndrome Conference Staff

Marilyn Barr, Founder and Executive Director
Steven Franks, Associate Director

Jodi Brown, Director of Development
Jodi Carlson, Hospital-Based Program Specialist
Nathan Clark, Marketing Director
Brenda Crow, Controller
Yvette Davis, Distribution Coordinator
Nicole Mark, Marketing Specialist
Mindi Petersen, Executive Assistant
Larry Stephens, Art Director
Bridgett Tasker, Conference Coordinator, Human Resources Manager
Amy Wicks, Information and Research Specialist
Joan Hunt, Volunteer



Wednesday, September 13

- 7:00 - 8:00 Pre Conference Registration
- 8:00 - 5:00 Pre Conference Institute
- 1:00 - 4:30 Presenter Preview
- 2:00 - 6:30 General Registration Opens
- 4:00 - 5:30 Family Reception and Presentations
- 6:30 - 8:00 Opening Keynote Address
- 8:00 - 9:30 Welcoming Reception

Thursday, September 14

- 7:00 - 5:30 Registration Desk Open
- 8:30 - 9:30 Keynote Address
- 9:30 - 9:50 Morning Break
- 9:50 - 10:50 Breakout Session A
- 11:00 - 12:00 Breakout Session B
- 12:00 - 1:15 Lunch Break
- 1:15 - 2:30 Keynote Address
- 2:30 - 2:50 Afternoon Break
- 2:50 - 3:50 Breakout Session C
- 4:00 - 5:00 Breakout Session D

Friday, September 15

- 8:00 - 5:30 Registration Desk Open
- 8:30 - 9:45 Keynote Address
- 9:45 - 10:00 Morning Break
- 10:00 - 11:00 Breakout Session A
- 11:10 - 12:10 Breakout Session B
- 12:10 - 1:30 Lunch Break
- 1:30 - 2:30 Breakout Session C
- 2:30 - 2:50 Afternoon Break
- 2:50 - 3:50 Breakout Session D
- 4:00 - 5:00 Breakout Session E

Saturday, September 16

- 8:00 - 12:30 Registration Desk Open
- 8:30 - 9:30 Closing Keynote Address
- 9:30 - 9:50 Morning Break
- 9:50 - 10:50 Breakout Session A
- 11:00 - 12:00 Breakout Session B

Table of Contents

Conference Partners and Supporters	2
Pre-Conference Institute	4
Family and Opening Reception	5
Family Information	15
General Information	17
Faculty List	20
Venue Map	22

PRE CONFERENCE INSTITUTE

Wednesday, September 13

8:00 a.m. - 5:00 p.m.

Kokopelli Grand



Challenges of Medical Testimony in the United Kingdom and the United States

8:00 a.m. – 12:00 p.m.

Session One – Challenges of Medical Testimony in the United Kingdom

Why the Cases Were Appealed: An Overview of the Problem Set

Tim David, MD, Booth Hall Children's Hospital, Blackley, Manchester, UK

An Overview of how the Pathologist Should Approach a Forensic Autopsy on Head Injury Cases; Examination Techniques for the CNS; Cellular Response to Trauma; Trauma vs. Natural Disease; DAI from Trauma and Other Neuropathology Issues

Lucy Rorke-Adams, MD, Children's Hospital of Philadelphia, Philadelphia, PA, USA

Case Details; Neuropathology and the Case Decision

Carole Jenny, MD, MBA, Brown Medical School, Providence, RI, USA

Biomechanical Issues Related to these Cases and Others

Gina Bertocci, PhD, PE, University of Louisville, Louisville, KY, USA

Summary: What the Experience Teaches Us and How it Affects Future Testimony and Statements from the Court of Appeals.

12:00 p.m. – 1:00 p.m. Lunch break

1:00 p.m. – 5:00 p.m.

Session Two – Challenges of Medical Testimony in the United States

In the second portion of this workshop information relating to current court room challenges to the scientific reliability of the SBS diagnosis in the United States will be discussed.

Brian Holmgren, JD, Office of the District Attorney, Nashville, TN, USA

Betty Spivack, MD, Office of the Chief Medical Examiner, Louisville, KY, USA



Wednesday, September 13

FAMILY RECEPTION

4:00 - 5:30 p.m.

White Pine I & II

Friends and relatives experience an incredible amount of grief when a child is injured or dies due to shaking. Many families have found the conferences help them connect with other families and provide a network for support. We invite you to attend a pre-conference gathering in honor of the children and families affected by shaken baby syndrome. A discussion will be held to highlight workshops that may be potentially difficult or of more interest to family members. A candlelight vigil and tribute to the families will also take place.

WEDNESDAY 6:30 – 8:00 p.m.

KEYNOTE ADDRESS

Kokopelli Grand

A World View of Cultural Practices Related to Shaken Baby Syndrome

Desmond Runyan, MD (Chapel Hill, NC, USA)

Recent surveys in a number of developed and developing countries have found remarkably high rates of children being shaken. Early data suggest that the problem of SBS may be much greater in the developing world. Dr. Runyan will review these data from surveys of parents in more than 15 countries and discuss the implications of these data for the well-being of children.

WELCOMING RECEPTION

8:00 - 9:30 p.m.

Forum

Join us under the stars in the forum for this year's celebration after our opening keynote address. Take this opportunity to develop new relationships with presenters, colleagues, family members and other professionals in a splendid outdoor setting. Participants will enjoy free hors d'oeuvres, a cash bar and dancing with Red Rock Country, a great local talent.



THURSDAY 8:30 – 9:30 a.m.

KEYNOTE ADDRESS

Kokopelli Grand

Animals, Crash Test Dummies, Computer Models and Human Infants: Making Sense of Biomechanical Controversies in SBS

Carole Jenny, MD, MBA (*Providence, RI, USA*)

THURSDAY 9:50 – 10:50 a.m.

Kokopelli I

Shaken/Impact Syndrome - Are We Looking in the Right Places?

James Downs, MD (*Albany, NY, USA*)

Kokopelli II

Shaken Baby Syndrome Prevention Program

Mark Dias, MD, FAAP (*Hershey, PA, USA*); Kim Smith, RN, BSN (*Hershey, PA, USA*); Kathy deGuehery, RN, BSN (*Buffalo, NY, USA*)

Kokopelli III

Biomechanics Research to Aid in the Detection of Child Abuse

Gina Bertocci, PhD, PE (*Louisville, KY, USA*)

White Pine I

Murder Convictions in SBS Cases in Canada

Jérôme Gagné, JD (*Montreal, QC, Canada*)

White Pine II

Investigation of Shaken Baby Syndrome (SBS)

Scott Peterson, Detective (*Ventura, CA, USA*)

Painted Horse I

Issues in Imaging: Nonaccidental Injury (NAI) of the Developing Brain

Gary L. Hedlund, DO (*Salt Lake City, UT, USA*)

Painted Horse II

Caught in the Abyss: Families in Crisis from Shaken Baby Syndrome

Pamela S. Rowse-Schmidt, RN (*Las Vegas, NV, USA*)

THURSDAY 11:00 – 12:00 p.m.

Kokopelli I

SBS: From Beginning to End – Part I

Randell Alexander, MD, PhD, FAAP (*Jacksonville, FL, USA*); Marjory D. Fisher, District Attorney (*Queens, NY, USA*); Wilbur Smith, MD, FAAP (*Detroit, MI, USA*); Philip Wheeler, DCI (*Abbots Langley, Herts, UK*)



Kokopelli II

Controversies in Abusive Head Trauma

Kent Hymel, MD (*Falls Church, VA, USA*); Carole Jenny, MD, MBA (*Providence, RI, USA*)

Kokopelli III

A Primer on Non-accidental Head Injury in Infants and Children

Edward E. Conway Jr., MD, MS, FAAP, FCCM (*Hartsdale, NY, USA*)

White Pine I

Law Enforcement Issues - A United Kingdom Perspective

Norman Inniss, Detective Inspector (*Kent, UK*)

White Pine II

Clinical/Neuroradiological/Biomechanical Correlates in Inflicted and Accidental Head Trauma in Infants and Children

Lori Frasier, MD, FAAP (*Salt Lake City, UT, USA*); Betty Spivack, MD (*Louisville, KY, USA*); Gary L. Hedlund, DO (*Salt Lake City, UT, USA*)

Painted Horse I

An Innovative and Culturally Sensitive Translation Process for SBS Prevention Programs

Marilyn Barr (*Vancouver, BC, Canada*); Jocelyn Conway (*Vancouver, BC, Canada*)

Painted Horse II

Working Through the Anger, Managing the Stress: The Aftereffects of Shaken Baby Syndrome from a Caregiver's Perspective

Carolyn E. Stinnett, PhD (*Knoxville, TN, USA*)

THURSDAY 1:15 - 2:30 p.m.

KEYNOTE ADDRESS

Kokopelli Grand

The Untold Stories: A Father's Perspective

Darryl Gibbs (*Yonkers, NY, USA*); Christopher Castens (*Alton, IL, USA*); Steven Rath (*Shillington, PA, USA*)

THURSDAY 2:50 - 3:50 p.m.

Kokopelli I

SBS: From Beginning to End – Part II

Randell Alexander, MD, PhD, FAAP (*Jacksonville, FL, USA*); Marjory D. Fisher, District Attorney (*Queens, NY, USA*); Wilbur Smith, MD, FAAP (*Detroit, MI, USA*); Philip Wheeler, DCI (*Abbots Langley, Herts, UK*)

Kokopelli II

Young Children with Inflicted and Noninflicted Traumatic Brain Injury: Neuropsychological and Neuroimaging Outcomes

Linda Ewing-Cobbs, PhD (*Houston, TX, USA*); Mary R. Prasad, PhD (*Houston, TX, USA*)



*Kokopelli III***The Prevalence of Neck Injuries Among Infants and Children with Fatal Inflicted Head Injury**Cindy Christian, MD (*Philadelphia, PA, USA*)*White Pine I***Retinal Hemorrhages in Shaken Baby Syndrome: What Have We Learned?**Alex V. Levin, MD, MHSc, FAAP, FAAO, FRCSC (*Toronto, ON, Canada*)*White Pine II***The Role of MRS in the Evaluation of Head Trauma in Suspected Child Abuse**Clare Sheridan-Matney, MD, FAAP (*Loma Linda, CA, USA*)*Painted Horse I***Clinical and Pathological Findings**Christine Bonnier, MD (*Brussels, Belgium*); Dominique Potelle (*Brussels, Belgium*); Patricia Marique (*Brussels, Belgium*)*Painted Horse II***Getting at the Numbers: A Simple Survey has Implications for SBS Prevention**Patricia E. Scibak, JD (*Worcester, MA, USA*); Timothy J. Wright, DO, MPH (*MA, USA*); Philip C. Nasca, PhD (*MA, USA*)**THURSDAY 4:00 – 5:00 p.m.***Kokopelli I***Visualizing Head Injury Biomechanics: From Head and Neck Kinematics, to Tissue Strains, to Injury**Stephen Boos, MD, FAAP (*North Potomac, MD, USA*)*Kokopelli II***Computer Modeling of Ocular Injury in Shaken Baby Syndrome**N. Rangarajan, PhD (*Boonsboro, MD, USA*); Carole Jenny, MD, MBA (*Providence, RI, USA*); Alex Levin, MD, MHSc, FAAP, FAAO, FRCSC (*Toronto, ON, Canada*)*Kokopelli III***Court Decisions in Shaken Baby/Abusive Head Trauma Cases**Allison Turkel, JD (*Alexandria, VA, USA*)*White Pine I***From Inspiration to Action - The Impact of a Health Promotion Video Program - The Shaken Baby Prevention Program in Western Sydney**Fran Tolliday, BSW (*Wentworthville, NSW, Australia*); Sue Foley, BSoc.Stud., MA, MSW, MED (*Sydney, NSW, Australia*); Paul Tait, MD (*Sydney, NSW, Australia*)

White Pine II

Death Disparity in Inflicted Injury: Implications for Prevention

David L. Chadwick, MD (*La Mesa, CA, USA*)

Painted Horse I

Keep Me Safe: One Hospital's Experience in Establishing a Shaken Infant Child Abuse Prevention Program

Clare Sheridan-Matney, MD, FAAP (*Loma Linda, CA, USA*); Mary Jo Vollmer-Sandholm, PNP (*Loma Linda, CA, USA*); Rebecca Piantini, MD (*Loma Linda, CA, USA*)

Painted Horse II

Use of Experts in Shaken Baby Cases: The Good, the Bad and the Ugly

Mary-Ann Burkhart, JD (*Arnold, MD, USA*)

FRIDAY 8:30 - 9:45 a.m.

KEYNOTE ADDRESS

Kokopelli Grand

Infant Crying and Shaken Baby Syndrome: The Evidence Base for a Prevention Program

Ronald G. Barr, MDMC, FRCPC (*Vancouver, BC, Canada*);
Leslie Francis, Parent (*Roy, UT, USA*)

FRIDAY 10:00 - 11:00 a.m.

Kokopelli I

Finding Sacred Ground within SBS: Reclaiming Trust

Andrew Sirotnak, MD (*Denver, CO, USA*); Robert Flory, MDiv (*Denver, CO, USA*)

Kokopelli II

Postmortem Detection and Evaluation of Hemorrhagic Retinopathy Using Monocular Indirect Ophthalmoscopy

Patrick E. Lantz, MD (*Winston-Salem, NC, USA*)

Kokopelli III

Inflicted Head Injury - Shaken Baby Syndrome in 2006: Facts, Fiction, and Controversy

Bruce Herman, MD (*Salt Lake City, UT, USA*); Timothy Kutz, MD (*St. Louis, MO, USA*)

White Pine I

The Top 10 Published Articles on SBS: What You Should Know

Robert Reece, MD (*North Falmouth, MA, USA*)

White Pine II

Forensic Pathology of Abusive Head Injury

Mary E. Case, MD (*St. Louis, MO, USA*)



*Painted Horse I***Legislating SBS Prevention: Advice from Legislators**George Lithco, JD (*Poughkeepsie, NY, USA*)*Painted Horse II***Blueprint for a Successful Hospital-based Multidisciplinary Team**Kathi L. Makoroff, MD (*Cincinnati, OH, USA*)**FRIDAY 11:10 - 12:10 p.m.***Kokopelli I***Physicians' Initial Forensic Impressions of Hypothetical Cases of Pediatric Traumatic Brain Injury**Kent P. Hymel, MD (*Falls Church, VA, USA*); Antionette L. Lasky, MD, MDH (*Indianapolis, IN, USA*)*Kokopelli II***Legal Track Part I - Critical Issues in the Investigation of SBS Cases**Paul Stern, JD (*Everett, WA, USA*); Brian Holmgren, JD (*Nashville, TN, USA*)*Kokopelli III***Effective Prevention Strategies: Using Normal Development to Teach and Prevent SBS**Sandra Alexander, MEd (*Atlanta, GA, USA*); Randell Alexander, MD, PhD, FAAP (*Jacksonville, FL, USA*); Ronald G. Barr, MDCM, FRCPC (*Vancouver, BC, Canada*)*White Pine I***Chronic Subdural Hematomas in Infants and Children**Christopher Greeley, MD (*Nashville, TN, USA*)*White Pine II***Why Collaborate?**Kim Kang (*Maple Plain, MN, USA*); Kathy Dittman (*Ft. Worth, TX, USA*); Wendi Schreiter (*Milwaukee, WI, USA*); Margaret M. Patterson, LMSW-ASP (*Dallas, TX, USA*); Michele Poole (*Lake Worth, FL, USA*)*Painted Horse I***Intervention Type Matters: Which Materials are Best for Increasing SBS Awareness and Prevention**Beth S. Russell, PhD (*Storrs, CT, USA*)*Painted Horse II***Hemophagocytic Lymphohistiocytosis (HLH) - Is It Really a Confounder for Shaken Baby Syndrome (SBS)?**Karen Kirhofer-Hansen, MD (*Salt Lake City, UT, USA*); Bruce Herman, MD (*Salt Lake City, UT, USA*)

FRIDAY 1:30 – 2:30 p.m.

*Kokopelli I***Research That Tells a Story: Hurricane Floyd's Effects on SBS Incidence and the North Carolina Study**

Heather Keenan, MDCM, MPH (*Salt Lake City, UT, USA*); Desmond Runyan, MD (*Chapel Hill, NC, USA*)

*Kokopelli II***Legal Track Part II - Presenting Effective Expert Testimony in SBS Cases**

Paul Stern, JD (*Everett, WA, USA*); Brian Holmgren, JD (*Nashville, TN, USA*)

*Kokopelli III***Visuals in Trial and Teaching: A New Interactive Exchange of Ideas**

James Lauridson, MD (*Montgomery, AL, USA*)

*White Pine I***Frequency of Occult Brain Injuries Found with Neuroimaging in Neurologically Asymptomatic Young Children Evaluated for Head Trauma: Nonaccidental Versus Accidental**

Kristin A. Fickenscher, MD (*Columbia, MO, USA*); David C. Mena, MD (*Columbia, MO, USA*); Irene R. Walsh, MD (*Kansas City, MO, USA*); Lisa H. Lowe, MD (*Columbia, MO, USA*); Adam C. Patterson, LMSW-ACP (*Columbia, MO, USA*)

*White Pine II***Natural, Accident or Homicide? Challenges of the Pediatric Forensic Autopsy**

Ross Reichard, MD (*Albuquerque, NM, USA*)

*Painted Horse I***Embracing the Hope Beyond the Grief**

Michael Burpee, Capt. USAF, LCSW (*Syracuse, UT, USA*); Care Burpee, Par-ent (*Syracuse, UT, USA*)

*Painted Horse II***A Call to Action: Advocacy in the SBS Community**

Kim Kang (*Maple Plain, MN, USA*)

FRIDAY 2:50 – 3:50 p.m.

*Kokopelli I***A Working Protocol for Investigators of Shaken Baby Syndrome**

David Parker, BS, M.Div (*Anchorage, AK, USA*)

*Kokopelli II***Legal Track Part III - Confronting Defense Experts and Untrue Defenses in SBS Cases**

Paul Stern, JD (*Everett, WA, USA*); Brian Holmgren, JD (*Nashville, TN, USA*)



*Kokopelli III***Difficulties for Experts in Head Trauma Cases in the United Kingdom**Tim David, MD (*Blackley, Manchester, UK*)*White Pine I***Out-patient Follow-up and Support After Shaken Baby Syndrome**Kathi L. Makoroff, MD (*Cincinnati, OH, USA*); Amy Thomas, MSW, LISW (*Cincinnati, OH, USA*)*White Pine II***Abuse or Accident? Discipline, Soothing, and Emotion Regulation in the Case of SBS Incidence**Beth S. Russell, PhD (*Storrs, CT, USA*)*Painted Horse I***A Unique Approach to Educating the Prison Population on SBS**Alisa Carroll, RN, BSN (*Columbus, OH, USA*)*Painted Horse II***Development of a Scoring System to Assess Retinal Hemorrhages****Special Session - Family Debriefing***Arrowhead II*

2:50 - 5:00 p.m.

Co Facilitated by: Michael Burpee, Capt. USAF, LCSW; Steven Franks, NCSBS

FRIDAY 4:00 - 5:00 p.m.*Kokopelli I***Categorizing Traumatic Brain Injuries: What are we Trying to Say?**Antoinette L. Laskey, MD, MPH (*Indianapolis, IN, USA*); Kent P. Hymel, MD (*Falls Church, VA, USA*)*Kokopelli II***Procurement to Prosecution: Prosecuting Abusive Head Trauma Cases When Organ Donation has Occurred**Thomas A. Nakagawa, MD, FAAP, FCCM (*Winston-Salem, NC, USA*); Jay Lapham, JD (*Fort Worth, TX, USA*)*Kokopelli III***Multidisciplinary Teams in Child Abuse Investigations**Kathryn Coffman, MD (*Phoenix, AZ, USA*); Russell Huber (*Phoenix, AZ, USA*); Gene Siegel (*Phoenix, AZ, USA*)*White Pine I***Preventing Abusive Head Injuries Through Hospital Based Parent Education: The Pennsylvania Shaken Baby Syndrome Prevention and Awareness Program**Kelly Cappos, RN, BSN, CPUR, CLNC (*Hershey, PA, USA*); Carroll Rottmund, RN, BSN, CCRN, CLNC (*Hershey, PA, USA*)

Painted Horse I

Undetected, Misdiagnosed, Under-reported ... Yet so Preventable: Two States' Approach to Reducing Shaken Baby Syndrome

Becky Ruffner, BA (*Prescott, AZ, USA*); Jetta Bernier, MA (*Boston, MA, USA*); Stephanie Zimmerman, MD (*Phoenix, AZ, USA*); Patrice Herberholz, RN (*Prescott, AZ, USA*)

Painted Horse II

Stress - It's Normal: "Have a Plan" - Helping Parents Prevent Tragedy

Carol Jenkins, MEd (*Seattle, WA, USA*)

SATURDAY 8:30 – 9:30 a.m.

KEYNOTE ADDRESS

Kokopelli Grand

Identification of Inflicted Traumatic Brain Injury in Well-Appearing Infants Using Serum and Cerebrospinal Markers

Rachel P. Berger MD, MPH (*Pittsburgh, PA, USA*)

SATURDAY 9:50 – 10:50

Kokopelli I

The Pediatric Brain Injury Research Network (PediBIRN)

Kent P. Hymel, MD (*Falls Church, VA, USA*)

Kokopelli II

REPEAT - Visualizing Head Injury Biomechanics: From Head and Neck Kinematics, to Tissue Strains, to Injury

Stephen Boos, MD, FAAP (*North Potomac, MD, USA*)

Kokopelli III

Deadly Daycare: Case Study of Shaken Baby Investigation/Prosecution

Aaron Holladay, Vancouver Police Department (*Vancouver, WA, USA*); Scott Jackson, Clark County Prosecutors Office (*Vancouver, WA, USA*)

White Pine I

Secondary Analysis of the "Love Me, Never Shake Me" SBS Education Program

Grace Evanoo, BSN, RN (*London, OH, USA*); Theresa Skybo, PhD, RN, CPNP (*London, OH, USA*)

White Pine II

The Feeding and Swallowing Patterns of Infants and Toddlers Following Traumatic Brain Injury Due to Child Abuse or Shaken Baby Syndrome.

Ellen Guess, OTR (*Broomfield, CO, USA*); Kim Keenan, MS, OTR (*Denver, CO, USA*); Cindy Durr, MD, CCC-SLP (*Denver, CO, USA*)



*Painted Horse I***Variable Bleeding in Shaken Baby Syndrome and Accidental Head Injury: A Role for Thrombophilic Factors?**

Anna Yu, MSc Student (*Toronto, ON, Canada*); Walter Kahr, MD, PhD (*Toronto, ON, Canada*); Leonardo Brandao, MD (*Toronto, ON, Canada*); Mark Nunes, MD (*Toronto, ON, Canada*); Alex Levin, MD, FAAP, MHSC, FAAO, FRCSC (*Toronto, ON, Canada*)

*Painted Horse II***Fundraising To Fund Prevention**

Michele Poole, Parent (*Lake Worth, FL, USA*)

SATURDAY 11:00 – 12:00 p.m.

*Kokopelli I***The Protective Effects of Child Care Centers Against Shaken Baby Fatalities: SBS in Centers Compared to Home-based Child Care**

Julia Wrigley, PhD (*New York, NY, USA*)

*Kokopelli II***Outcomes in Non-accidental Head Injury**

Sarah Gander, MD (*Kingston, ON, Canada*); D. Samdup, MD (*Kingston, ON, Canada*); RG Smith, MBBS, FRCPC (*Kingston, ON, Canada*)

*Kokopelli III***Development and Implementation of a Child Abuse Prevention Program Directed to Adolescents and High-risk Parents with Prevention Efforts Focusing on Shaken Baby Syndrome, Relational Violence, and Drug and Alcohol Affected Infants**

Leila Keltner, MD, PhD (*Portland, OR, USA*); Debby Kernan, MA, LPC (*Portland, OR, USA*)

*White Pine I***Nurses and Healthcare Providers: The Foundation for SBS Education, Prevention and Prosecution**

Pamela Rowse-Schmidt, RN (*Las Vegas, NV, USA*); Bev Byron, RN, MSN (*Silver Spring, MD, USA*)

*White Pine II***Preventing Shaken Baby Syndrome Using a Directed Parent Approach**

Wilma Zeemering, RN, BA (*Detroit, MI, USA*); Rosalynn Bliss, MSW (*Detroit, MI, USA*); Amy Combs, MSW (*Grand Rapids, MI, USA*); Michael Stoiko, MD (*Grand Rapids, MI, USA*)

*Painted Horse I***Salem Corey a SBS Non-survivor**

Jackie Hogan, Parent (*Murray, UT, USA*); Karen Pritchett, Grandparent (*Murray, UT, USA*)



We recognize that families may need additional support and services during their stay in Park City, Utah. We will make every effort to ensure your needs are met during your stay. The Canyons is well equipped to handle the daily needs of your children, provide access to the different levels of the hotel and throughout the village.

Medical Care

The nearest hospital services during the conference are located at the Heber Valley Medical Center, 1485 South Highway 40, Heber City, UT 84032. Heber City is approximately 20 minutes from downtown Park City. You can access their website for a list of clinics, hospital services and physicians at <http://intermountainhealthcare.org/xp/public/hebervalley/>

Family Retreat Room

Arrowhead II

A designated room will be located near conference sessions for use by family members. This area is available for debriefing time, networking, and will have space for children to rest. No childcare attendant will be available; parents are expected to watch their own children at all times.

Family Debriefing and Support

The National Shaken Baby Coalition has offered their support and services to family members who may be in need of additional mentoring during the conference. They will have an exhibit set up in the conference lobby.

Additional counseling and support is available through the generosity of Michael Burpee, Capt., USAF, LCSW. He will be available throughout the conference for family members who may need to talk. Please check with the National Shaken Baby Coalition members for additional information.

A family debriefing meeting is scheduled on Friday, September 15 from 2:50 - 5:00 pm in the Arrowhead II room. This session is limited to family member attendees and will provide an outlet for families to discuss the conference, their emotions surrounding the conference and offer additional mentoring to those families who may need assistance



PREVENTION FILM PREVIEW

Friday, September 15

Arrowhead Room I

The National Center on Shaken Baby Syndrome is offering a chance for our participants to view some of the most popular prevention films at this year's conference. Prevention specialists will be available to answer your questions about the films being shown. Films will be shown every half-hour.

10:00

Mighty Like a Rose (Rob and Annette Rust)

Mighty Like a Rose describes Kelly Deaun Rust's strength, spirit and will to survive. The film brings viewers into the home of Kelly to hear accounts from her parents and her sister about Kelly's short life, her perseverance and the difficulties of raising a severely handicapped child.

10:30

Elijah's Story (Emily Bodily)

The story of Elijah, a 16-month-old baby boy who was shaken to death by his biological father. This film follows the young family from the birth of Elijah to the 911 emergency call and the sentencing hearing. Elijah's mom shares her emotions as she tries to go on, and Elijah's dad speaks out from prison encouraging others to learn from his actions.

11:00

Have a Plan (Denise Isings)

Have a Plan. Frustration is Normal! What will you do when you are frustrated by your baby's crying? *Have a Plan....* for yourself and share it with anyone that you leave your baby with.

11:30

Don't Shake Jake (Pam Belisle)

This five-minute video is a synopsis of what Shaken Baby Syndrome is. This video is a tool to initiate conversation about Shaken Baby Syndrome and that it is a crime that can hit any home in the world. The sound of a baby crying is made annoying by design it is how we handle the stress of the crying that is the key to preventing Shaken Baby Syndrome.

1:30

Skipper Initiative (George Lithco)

2:00

Portrait of Promise (Jane Swenson)

Portrait of Promise is designed to educate a wide variety of audiences about a form of child abuse called Shaken Baby Syndrome. This video features 3 families whose lives have been devastated by Shaken Baby Syndrome. The program is serious, but provides hope in that it reminds the viewer "the key to preventing Shaken Baby Syndrome lies in our hands."



GENERAL INFORMATION

Registration

General conference registration entitles participants to the following:

- All general conference sessions
- All breakout conference sessions
- Attendance at the welcoming reception
- Attendance at the family reception
- Conference syllabus and handouts on CD-ROM
- Morning and afternoon beverage breaks

Dining

Lunch breaks will be 1 hour and 15 minutes. There are many options available in the resort center and we encourage participants to eat onsite so they are not late for afternoon sessions. An optional theme buffet or box lunch will be available for \$15 each day. A limited number is still available and is payable at the registration desk.

Networking Opportunities

Hospital Based Prevention Meeting

Hospital based prevention program specialists, and other interested parties, are invited to attend a meeting in the White Pine ballroom on Thursday, September 14 from 5:00 p.m. - 6:30 p.m. to discuss pragmatic ideas for implementation, overcoming challenges and sharing successes. The meeting will be hosted by National Center on Shaken Baby Syndrome hospital program specialist Jodi Carlson.

National Association of Children's Hospitals and Related Institutions

The National Association of Children's Hospitals and Related Institutions (NACHRI) is hosting a luncheon for it's members on Friday, September 15 at 12:00 p.m. in Doc's. Join colleagues for an open exchange of ideas and information. This provides an opportunity to influence NACHRI's ongoing work to support roles in treating and preventing child abuse and neglect. Registration for this luncheon is restricted to NACHRI member hospitals. For more information please check in at the registration desk.

Restaurants

Park City's many award-winning restaurants are among the finest in the Intermountain West, reflecting many different culinary styles and influences. There's something for every taste and every mood — and since everything's so close, they're all within walking distance or a short free bus ride away. Please see the Mountain Express Magazine in your conference bag for more details.



GENERAL INFORMATION

Park City Activities

This former Olympic town offers a wide variety of before and after meeting activities to choose from. Attendees can take advantage of Park City's three year-round resorts and Utah Olympic Park activities, including scenic chairlift rides, lift-serviced hiking and biking, alpine slides, zip lines, bobsled rides, and horseback riding. Additional activities include golf, fly-fishing, and gallery strolls. Meeting attendees can also satisfy their urge for shopping on Historic Main Street, Redstone Shopping Center or the 60 brand name manufacturer and designer stores at the Tanger Outlet Center.

Exhibits

Exhibits will be open to our conference attendees from 8:00 a.m. - 5:30 p.m. on Wednesday - Friday and 8:00 a.m. - 12:00 p.m. on Saturday.

Conference Evaluations

Evaluations for the breakout and general sessions are located in your conference bag. Baskets will be located at the back of each breakout room as well as at the registration desk for completed forms. We appreciate your comments, they are reviewed and considered carefully in the planning of our future conferences.

Phones

Please turn off all cell phones and pagers during conference sessions so as to not disturb the presenters or the other attendees.

Emergency messages will be posted at the registration desk. Please direct home/office messages to your hotel room.

Conference Assistance

If at any time you need assistance while attending the conference, please visit our registration desk. Conference staff can be identified by their yellow colored badges and are available to assist you.

Program Changes

All changes to the program will be announced during the keynote sessions as well as posted at the registration desk.

The views presented in conference sessions or at exhibits do not imply endorsement by the National Center on Shaken Baby Syndrome, the planning committee or any other conference supporter.



TRAVEL AND PARKING AROUND PARK CITY

Around Town

Park City Transit provides free bus transportation throughout the Park City area. Buses run approximately every 20 minutes between 7:30 a.m. to 10:30 p.m. Seating is limited on these buses, so the conference will also have additional transportation through All Resort shuttle service for a nominal fee (\$10.00 per person for a two day pass). This can be paid for onsite at the registration desk.

CONTINUING EDUCATION CREDITS



This activity has been planned and implemented in accordance with the Essential Areas and Policies of the Accreditation Council for Continuing Medical Education through a joint sponsorship of Primary Children's Medical Center, the Department of Pediatrics at the University of Utah School of Medicine and the National Center on Shaken Baby Syndrome. Primary Children's Medical Center is accredited by the ACCME to provide continuing medical education for physicians.

AMA PRA Category 1 Credit

Primary Children's Medical Center designates this educational activity for a maximum of 16.5 AMA PRA Category 1 Credits™ and a maximum of 8.0 AMA PRA Category 1 Credits™ for the optional pre-conference. Physicians should only claim credit commensurate with the extent of their participation in the activity.



This educational activity offers 9.6 nursing contact hours for the optional pre-conference and 19.8 nursing contact hours for the general conference. Primary Children's Medical Center is an approved provider of continuing nursing education by the Utah Nurses Association, an accredited approver by the American Nurses Credentialing Center's Commission on Accreditation.

Other Continuing Education Credits – Additional credits must be obtained through participants' individual states or provinces. Certificates will be available for participants who wish to apply for these additional credits through their own agency.



CONFERENCE FACULTY

Alexander, Randell, MD, PhD, FAAP, Jacksonville, FL, USA
Alexander, Sandra, M.Ed, Atlanta, GA, USA
Barr, Marilyn, BS, SSW, Vancouver, BC, Canada
Barr, Ronald G., MDCM, FRCPC, Vancouver, BC, Canada
Berger, Rachel, MD, MPH, Pittsburgh, PA, USA
Bernier, Jetta, MA, Boston, MA, USA
Bertocci, Gina, PhD, PE, Louisville, KY, USA
Bliss, Rosalynn, MSW, Detroit, MI, USA
Bonnier, Christine, MD, Brussels, Belgium
Boos, Stephen, MD, FAAP, North Potomac, MD, USA
Brandao, Leonardo, MD, Toronto, ON, Canada
Burkhard, Mary-Ann, JD, Arnold, MD, USA
Burpee, Care, Parent, Syracuse, UT, USA
Burpee, Michael, Captain, LCSW, Syracuse, UT, USA
Byron, Beverly, RN, MSN, Silver Spring, MD, USA
Cappos, Kelly, RN, BSN, CPUR, CLNC, Hershey, PA, USA
Carrroll, Alisa, RN, BSN, Columbus, OH, USA
Case, Mary E., MD, St. Louis, MO, USA
Castens, Chris, Alton, IL, USA
Chadwick, David L., MD, La Mesa, CA, USA
Cheng, J., South Yorkshire, UK
Christian, Cindy, MD, Philadelphia, PA, USA
Cirovic, S., Dip. Eng., MASc, PhD, South Yorkshire, UK
Coffman, Kathryn, MD, Phoenix, AZ, USA
Combs, Amy, MSW, Grand Rapids, MI, USA
Conway, Edward E., MD, MS, FAAP, FCCM, Hartsdale, NY, USA
Conway, Jocelyn, Vancouver, BC, Canada
David, Tim, MD, Blackley, Manchester, UK
deGuehery, Kathy, RN, BSN, Buffalo, NY, USA
Dias, Mark, MD, FAAP, Hershey, PA, USA
Dittman, Kathy, Ft. Worth, TX, USA
Downs, James C., MD, Albany, NY, USA
Durr, Cindy, MD, CCC-SLP, Denver, CO, USA
Evanoo, Grace, BSN, RN, London, OH, USA
Ewing-Cobbs, Linda, PhD, Houston, TX, USA
Fickenscher, Kristin A., MD, Columbia, MO, USA
Fisher, Marjory, JD, Queens, NY, USA
Flory, Robert, MDiv, Denver, CO, USA
Foley, Sue, B.Soc Stud, MA, MSW, MEd, Sydney, NSW, Australia
Francis, Leslie, Parent, Roy, UT, USA
Frasier, Lori, MD, FAAP, Salt Lake City, UT, USA
Gagné, Jérôme, JD, Montréal, QC, Canada
Gander, Sarah, MD, Kingston, ON, Canada
Gibbs, Darryl, BS, Yonkers, NY, USA
Greeley, Christopher, MD, Nashville, TN, USA
Guess, Ellen, OTR, Broomfield, CO, USA
Hedlund, Gary L., DO, Salt Lake City, UT, USA
Herberholz, Patrice, RN, Prescott, AZ, USA
Herman, Bruce, MD, Salt Lake City, UT, USA
Hogan, Jackie, Parent, Murray, UT, USA
Holladay, Aaron, Vancouver Police Dept., Vancouver, WA, USA
Holmgren, Brian, JD, Nashville, TN, USA
Howard, I.C., BSc, PhD, South Yorkshire, UK
Huber, Russell, Phoenix, AZ, USA
Hymel, Kent P., MD, Falls Church, VA, USA
Inniss, Norman, Detective Inspector, Kent, UK
Jackson, Scott, Clark County Prosecutor's Office, Vancouver, WA, USA
Jenkins, Carol, M.Ed, Seattle, WA, USA
Jenny, Carole, MD, MBA, Providence, RI, USA
Kahr, Walter, MD, PhD, Toronto, ON, Canada
Kang, Kim, Maple Plain, MN, USA
Keenan, Heather, MDCM, MPH, Salt Lake City, UT, USA
Keenan, Kim, MS, OTR, Denver, CO, USA
Keltner, Leila, MD, PhD, Portland, OR, USA
Kernan, Debby, MA, LPC, Portland, OR, USA
Kirhofer-Hansen, Karen, MD, Salt Lake City, UT, USA
Kutz, Timothy, MD, St. Louis, MO, USA
Lantz, Patrick E., MD, Winston-Salem, NC, USA
Lapham, Jay, JD, Ft. Worth, TX, USA
Laskey, Antoinette L., MD, MPH, Indianapolis, IN, USA
Lauridson, James, MD, Montgomery, AL, USA



CONFERENCE FACULTY

Levin, Alex V., MD, MHSc, FAAP, FAAO, FRCSC, Toronto, ON, Canada
Lithco, George, JD, Poughkeepsie, NY, USA
Lowe, Lisa H., MD, Columbia, MO, USA
Makoroff, Kathi L., MD, Cincinnati, OH, USA
Marique, Patricia, Brussels, Belgium
Mena, David C., MD, Columbia, MO, USA
Nakagawa, Thomas A., MD, FAAP, FCCM, Winston-Salem, NC, USA
Nasca, Philip C., PhD, Boston, MA, USA
Nunes, Mark, MD, Toronto, ON, Canada
Parker, David, BS, M.Div, Anchorage, AK, USA
Patterson, Margaret M., LMSW-ASP, Dallas, TX, USA
Patterson, Adam C., LMSW-ACP, Columbia, MO, USA
Peterson, Scott, Detective, Ventura, CA, USA
Piantini, Rebecca, MD, Loma Linda, CA, USA
Poole, Michele, Parent, Lake Worth, FL, USA
Potelle, Dominique, Brussels, , Belgium
Prasad, Mary R., PhD, Houston, TX, USA
Pritchett, Karen, Grandparent, Murray, UT, USA
Rangarajan, N., PhD, Boonsboro, MD, USA
Rath, Steven, Shillington, PA, USA
Reece, Robert, MD, North Falmouth, MA, USA
Reichard, Ross, MD, Albuquerque, NM, USA
Rorke-Adams, Lucy, MD, Philadelphia, PA, USA
Rottmund, Carol, RN, BSN, CCRN, CLNC, Hershey, PA, USA
Rowse, Pamela, RN, Las Vegas, NV, USA
Ruffner, Becky, BA, Prescott, AZ, USA
Runyan, Desmond, MD, Chapel Hill, NC, USA
Russell, Beth S., PhD, Storrs, CT, USA
Samdup, D., MD, Kingston, ON, Canada
Schreiter, Wendi, Milwaukee, WI, USA
Scibak, Patricia E., JD, Worcester, MA, USA
Sheridan -Matney, Clare, MD, FAAP, Loma Linda, CA, USA
Siegel, Gene, Phoenix, AZ, USA
Sirotnak, Andrew, MD, Denver, CO, USA
Skybo, Theresa, PhD, RN, CPNP, London, OH, USA
Smith, Wilbur, MD, FAAP, Detroit, MI, USA
Smith, Kim, RN, BSN, Hershey, PA, USA
Smith, RG, MBBS, FRCPC, Kingston, ON, Canada
Spivack, Betty, MD, Louisville, KY, USA
Stern, Paul, JD, Everett, WA, USA
Stinnett, Carolyn E., PhD, Knoxville, TN, USA
Stoiko, Michael, MD, Grand Rapids, MI, USA
Tait, Paul, MD, Sydney, NSW, Australia
Thomas, Amy, MSW, LISW, Cincinnati, OH, USA
Tolliday, Fran, BSW, Wentworthville, NSW, Australia
Turkel, Allison, JD, Alexandria, VA, USA
Vollmer-Sandholm, Mary Jo, PNP, Loma Linda, CA, USA
Walsh, Irene R., MD, Kansas City, MO, USA
Wheeler, Philip, DCI, Abbots Langley, Herts, UK
Wright, Timothy J., DO, MPH, MA, USA
Wrigley, Julia, PhD, New York, NY, USA
Yu, Anna, MSc Student, Toronto, ON, USA
Zimmerman, Stephanie, MD, Cincinnati, OH, USA
Zeemering, Wilma, RN, BA, Detroit, MI, USA



VENUE MAP

GRAND SUMMIT RESORT HOTEL

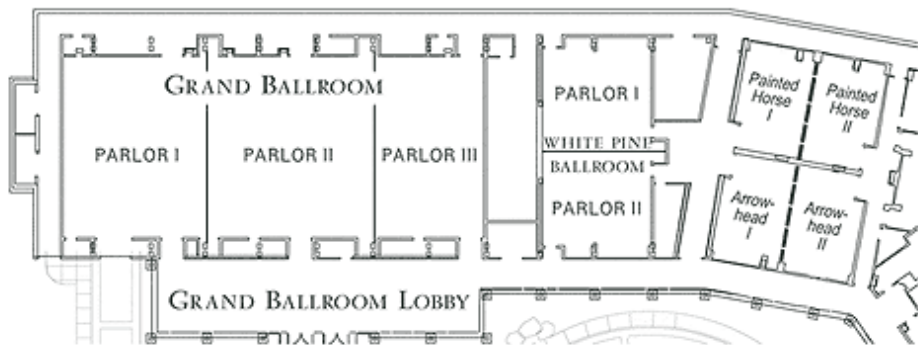

Child, Family, Learning



Centre for Child, Family, Learning

Centre for Child, Family, Learning, University of Bath, Bath, BA2 9AT

Professor Catherine Snow

Sheldon Bley Syndrome

www.ccfhl.org